

CHASSIS FABRICATION

HOW BENDS ARE MEASURED

The degree of a bend may be measured with either a protractor or an angle finder.

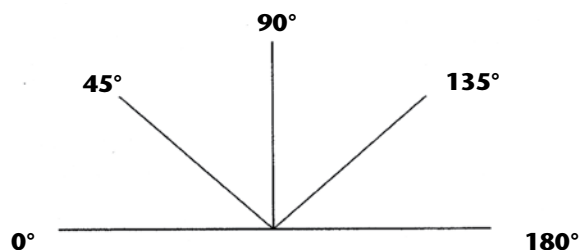

BEND INFORMATION

The bend radius is measured on the "centerline" of the tube. Radius is determined by the tooling available. The leg length is the straight portion, starting from the tangent point (where the bend starts).

For bend radius, maximum degree of bend, minimum leg length, and minimum wall thickness information, please refer to the "custom tube bending" chart on page 6.

EXAMPLES

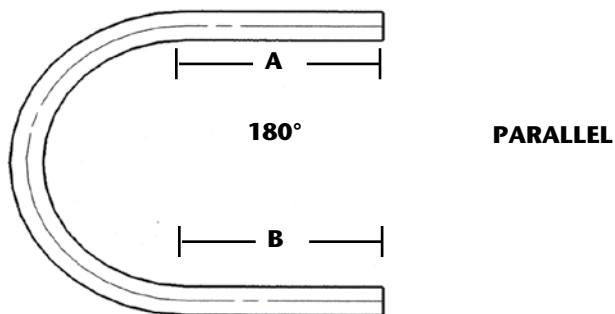
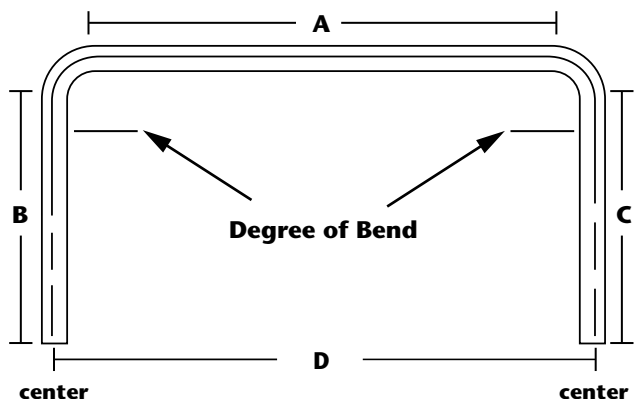
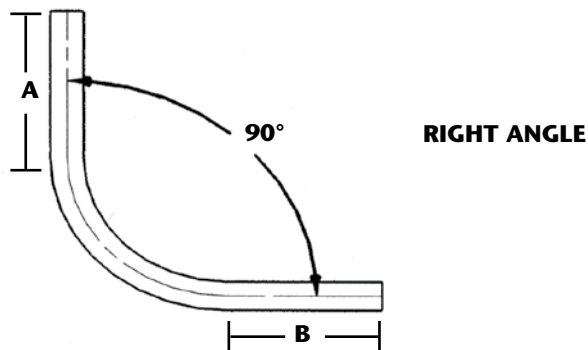
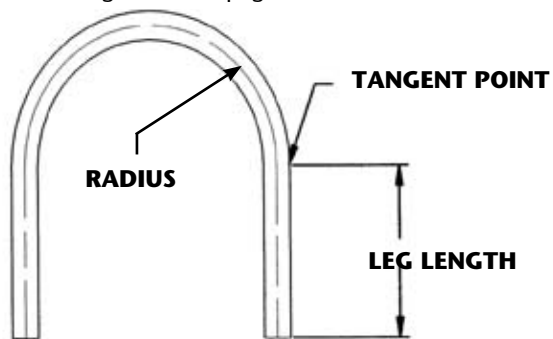
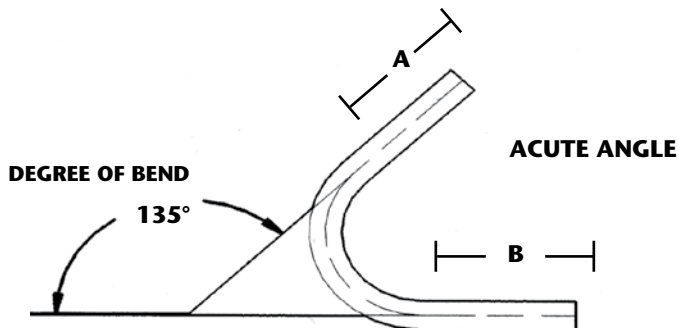
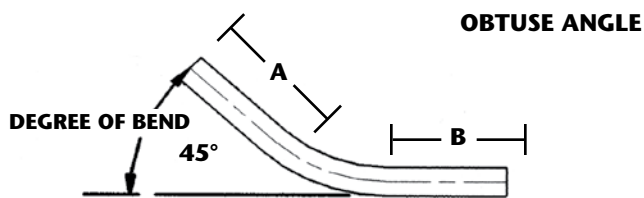

CUSTOM TUBE BENDING

We offer custom tube bending of our material. Our minimum basic single bend cost is **\$25.00** per bend plus material. Complex pieces requiring additional layout time will be charged accordingly. Our sales people can provide assistance and quoting. Mail or fax us a drawing using the information listed on the chart below as your guide on our available tooling. Allow 5-10 working days for scheduling.

TUBE DIA.	BEND RADIUS	MIN. WALL THICKNESS	MIN. LEG LENGTH	MAX. DEGREE OF BEND
3/8"	15/16"	.035"	1-1/2"	180
1/2"	1-1/2"	.035"	2"	180
3/4"	4"	.049"	3"	120
7/8"	4"	.058"	3"	120
1"	5-1/2"	.058"	4-3/4"	180
1-1/8"	5-1/2"	.058"	4-7/8"	180
1-1/4"	6"	.058"	5"	180
1-3/8"	6"	.058"	5"	180
1-1/2"	6"	.065"	7"	180
1-5/8"	7"	.065"	7-1/2"	180

Custom bending is performed for the diameters listed above only.

REQUIRED INFORMATION FOR CUSTOM BENDING A FIVE POINT CAGE KIT

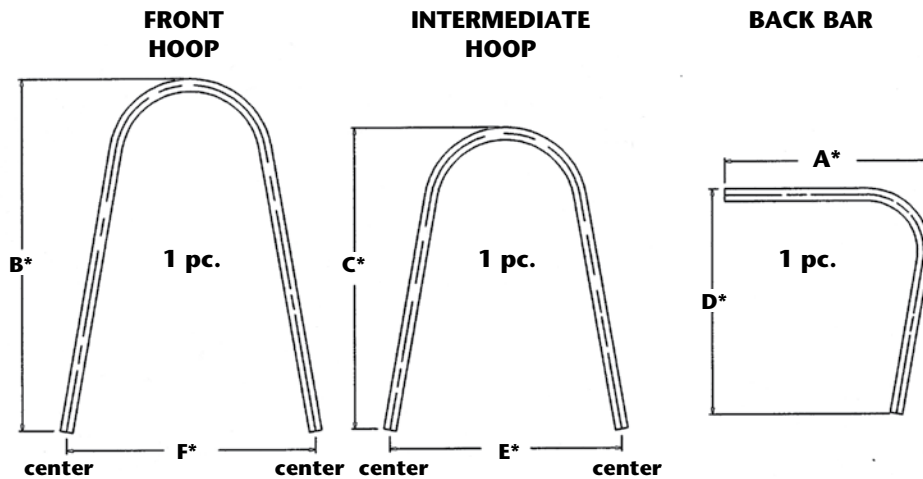

REQUIRED INFORMATION FOR CUSTOM BENDING A SIX POINT CAGE KIT

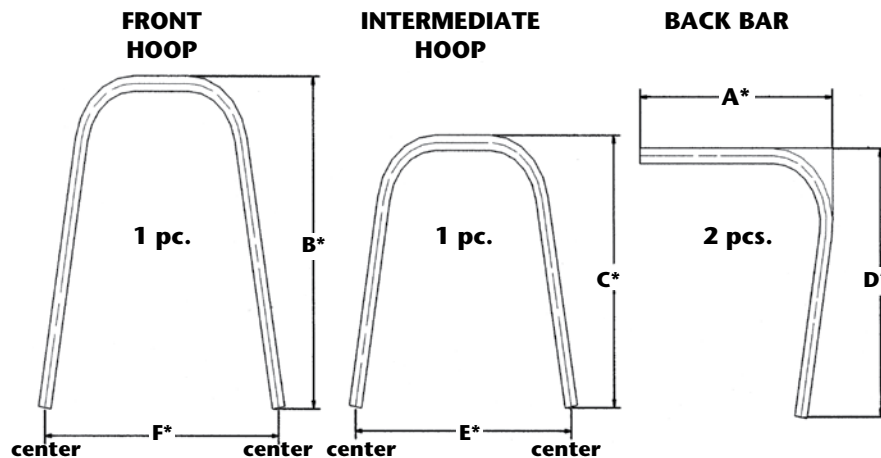

PRE-BENT TUBING

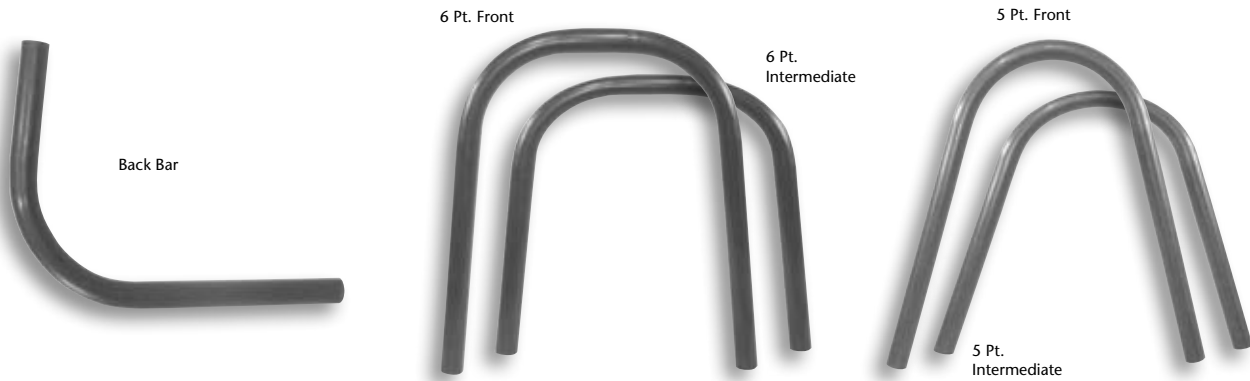

PRE-BENT CHROMOLY TUBING

See page 6 for custom tube bending information.

PART #	DESCRIPTION	TUBE SIZE	DIMENSIONS	PRICE
C42-280*	SHOULDER HOOP CENTERS x 72" LONG	1-3/8" x .058" * Includes 8" pc. of 41-114-058	20-1/2" CENTERS x 72" LONG	\$124.95
C42-283*	SHOULDER HOOP (JR DRAGSTER)	1-1/8" x .058" * Includes 8" pc. of 41-1-058	17-1/2" CENTERS x 60" LONG	\$109.95
C42-286	SEAT FORM BARS (PR)	1-1/4" x .058"		\$57.95
C42-288	SEAT FORM BARS (PR)	7/8" x .058" (JR DRAGSTER)		\$60.95
C42-290	5-PT FRONT HOOP	1-1/2" x .065" (SNG BEND)	26" TALL x 20" CENTERS	\$64.95
C42-294	5-PT FRONT HOOP	1-5/8" x .083" (SNG BEND)	26" TALL x 20" CENTERS	\$72.95
C42-297	6-PT FRONT HOOP (JR DRAGSTER)	1-1/8" x .058" (DBL BEND)	21" TALL x 17" CENTERS	\$62.95
C42-302	6-PT FRONT HOOP	1-1/2" x .065" (DBL BEND)	26" TALL x 20" CENTERS	\$76.95
C42-306	6-PT FRONT HOOP	1-5/8" x .083" (DBL BEND)	26" TALL x 20" CENTERS	\$85.95
C42-291	5-PT INTERMEDIATE HOOP	1-1/2" x .065" (SNG BEND)	22" TALL x 21" CENTERS	\$58.95
C42-295	5-PT INTERMEDIATE HOOP	1-5/8" x .083" (SNG BEND)	22" TALL x 21" CENTERS	\$67.95
C42-298	6-PT INTERMEDIATE HOOP (JR DRAGSTER)	1-1/8" x .058" (DBL BEND)	17" TALL x 18" CENTERS	\$58.95
C42-303	6-PT INTERMEDIATE HOOP	1-1/2" x .065" (DBL BEND)	22" TALL x 21" CENTERS	\$72.95
C42-307	6-PT INTERMEDIATE HOOP	1-5/8" x .083" (DBL BEND)	22" TALL x 21" CENTERS	\$79.95
C42-292	BACK BAR	1-1/2" x .065"	17" TALL x 15" DEEP x 80 DEGREE BEND	\$47.95
C42-296	BACK BAR	1-5/8" x .083"	17" TALL x 15" DEEP x 80 DEGREE BEND	\$51.95
C42-299	BACK BAR (JR DRAGSTER)	1-1/8" x .058"	16" TALL x 13" DEEP x 80 DEGREE BEND	\$40.95

CHROMOLY HEAD BAR KIT

Pre-bent chromoly tubing for the horizontal head bar, required for a complete cage installation.

PART #	DESCRIPTION	TUBE SIZE	DIMENSIONS	PRICE
C42-279	HEAD BAR	1" x .058"	6" STRAIGHT LEG x (2) 90 DEGREE BENDS 18" STRAIGHT LEG	\$58.95



DRAGSTER ROLL BAR PAD^{SFI CERTIFIED 45.1}

Provides neat and clean compliance with NHRA roll bar pad requirement. Fits all standard dragster type cages using 1", 1-1/2", and 1-5/8" tubing. Available in a 3' long piece or as a kit. Part numbers C72-150 and C72-156 include Velcro for easy installation.



PART #	DESCRIPTION	APPLICATION	PRICE
C72-150	KIT (2) 18" PCS, (2) 13" PCS, AND (1) 4" PC	1-1/2" AND 1-5/8" TUBE	\$87.95
C72-156	3' PAD KIT (5/8" THK)	1-1/2" AND 1-5/8" TUBE	\$37.95
C72-157*	3' PAD (5/8" THK)	1" TUBE	\$37.95

* Does not include Velcro.



PRE-BENT CHROMOLY CAGES

If you're building a new car or updating your current race car, these affordable pre-bent chromoly pieces are perfect for the professional chassis builder and the do-it-yourselfer. You may choose from our standard cage kits or individual pieces, which will fit most installations. We also offer custom cage kits built to your specifications.

PART #	DESCRIPTION	TUBE SIZE	RADIUS	PRICE
C42-270	5 PT	1-1/2" x .065"	6"	\$135.95
C42-271	5 PT	1-5/8" x .083"	7"	\$155.95
C42-274	6 PT	1-1/8" x .058"	5-1/2"	\$124.95
	JR DRAGSTER			
C42-275	6 PT	1-1/2" x .065"	6"	\$188.95
C42-276	6 PT	1-5/8" x .083"	7"	\$211.95

Note: 1-1/8" dia. cages are bent on a 5-1/2" radius, 1-1/2" dia. cages are bent on a 6" radius and 1-5/8" dia. cages are bent on a 7" radius. All kits include our standard pre-bent chromoly tubing.



5-pt Cage

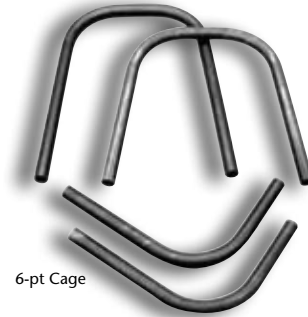

6-pt Cage

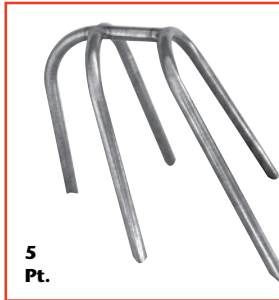

5 Pt.

Examples After Assembly.



6 Pt.

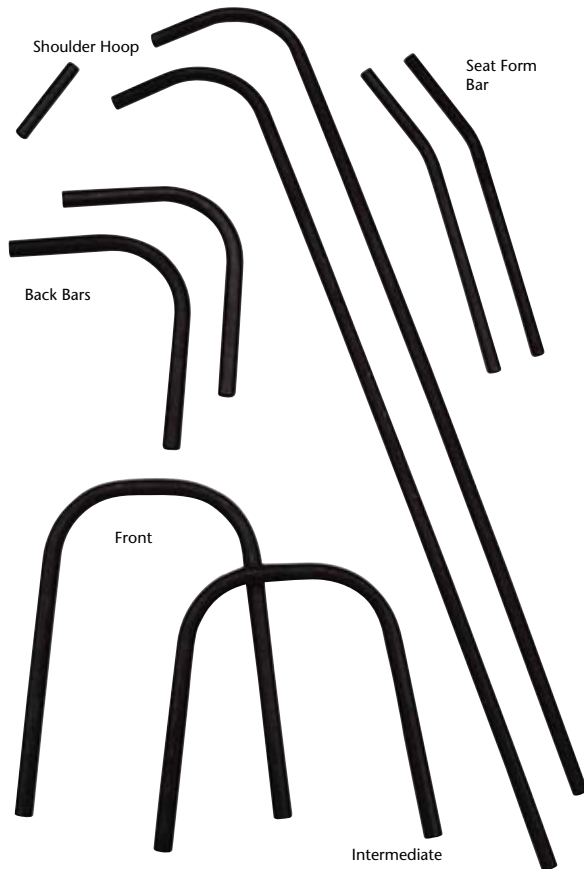

PRE-BENT PACKAGES

Everything you need with just one part number for easy ordering. Assembled with our pre-bent chromoly tubing, listed on page 7.

PART #	#	DESCRIPTION	CAGE KIT	SHOULDER HOOP	SEAT FORMERS	PRICE
C42-320	6 PT		1-1/2" x .065"	1-3/8" x .058"	1-1/4" x .058"	\$365.95
C42-323	6 PT		1-5/8" x .083"	1-3/8" x .058"	1-1/4" x .058"	\$389.95
C42-326	6 PT	JR DRAGSTER	1-1/8" x .058"	1-1/8" x .058"	7/8" x .058"	\$288.95

INCLUDES

KIT NUMBER	FRONT HOOP	INTERMEDIATE HOOP	BACK BAR (2)	SEAT FORM BAR (2)	SHOULDER HOOP
C42-320	C42-302	C42-303	C42-292	C42-286	C42-280
C42-323	C42-306	C42-307	C42-296	C42-286	C42-280
C42-326	C42-297	C42-298	C42-299	C42-288	C42-283

Individual parts listed on page 7.

LEFT HAND ROUND TUBE ADAPTERS

These weld-in threaded tube adapters are perfect for construction of linkage and suspension components. Adapters are CNC machined 4130 chromoly to precise tolerances with a jewelry quality finish. Left hand tube adapters are marked with grooves for easy identification during assembly. Left hand tube adapters with hex option also available in select sizes.

LEFT HAND ROUND TUBE ADAPTERS

FITS TUBE SIZE	THREAD SIZE	PACK OF (2)	DISCOUNT PRICE PER PACK			BAG OF (20)	DISCOUNT PRICE PER BAG		DIAGRAM PAGE 10		
			1-9	10-19	20+		(1) BAG	(2) BAGS	A	B	C
*5/16" OD	10-32	C73-801-2	\$10.54	\$8.43	\$6.75	C73-801-20	\$84.32	\$67.45	.510	.415	.320
*3/8" OD	10-32	C73-807-2	\$10.54	\$8.43	\$6.75	C73-807-20	\$84.32	\$67.45	.510	.415	.380
1/2" OD X .058"	1/4-28	C73-813-2	\$10.54	\$8.43	\$6.75	C73-813-20	\$84.32	\$67.45	.510	.415	.382
5/8" OD X .058"	5/16-24	C73-819-2	\$10.54	\$8.43	\$6.75	C73-819-20	\$84.32	\$67.45	.510	.415	.507
5/8" OD X .058"	3/8-24	C73-821-2	\$10.54	\$8.43	\$6.75	C73-821-20	\$84.32	\$67.45	.510	.415	.507
3/4" OD X .058"	5/16-24	C73-835-2	\$11.00	\$8.80	\$7.04	C73-835-20	\$88.00	\$70.40	.65	.55	.632
3/4" OD X .058"	3/8-24	C73-837-2	\$11.00	\$8.80	\$7.04	C73-837-20	\$88.00	\$70.40	.65	.55	.632
3/4" OD X .058"	7/16-20	C73-839-2	\$11.00	\$8.80	\$7.04	C73-839-20	\$88.00	\$70.40	.65	.55	.632
3/4" OD X .065"	5/16-24	C73-841-2	\$11.00	\$8.80	\$7.04	C73-841-20	\$88.00	\$70.40	.65	.55	.618
3/4" OD X .065"	3/8-24	C73-843-2	\$11.00	\$8.80	\$7.04	C73-843-20	\$88.00	\$70.40	.65	.55	.618
3/4" OD X .065"	7/16-20	C73-845-2	\$11.00	\$8.80	\$7.04	C73-845-20	\$88.00	\$70.40	.65	.55	.618
7/8" OD X .058"	3/8-24	C73-859-2	\$12.10	\$9.68	\$7.74	C73-859-20	\$96.80	\$77.44	.79	.56	.757
7/8" OD X .058"	7/16-20	C73-861-2	\$12.10	\$9.68	\$7.74	C73-861-20	\$96.80	\$77.44	.79	.56	.757
7/8" OD X .058"	1/2-20	C73-863-2	\$12.10	\$9.68	\$7.74	C73-863-20	\$96.80	\$77.44	.79	.56	.757
7/8" OD X .065"	3/8-24	C73-865-2	\$12.10	\$9.68	\$7.74	C73-865-20	\$96.80	\$77.44	.79	.56	.743
7/8" OD X .065"	7/16-20	C73-867-2	\$12.10	\$9.68	\$7.74	C73-867-20	\$96.80	\$77.44	.79	.56	.743
7/8" OD X .065"	1/2-20	C73-869-2	\$12.10	\$9.68	\$7.74	C73-869-20	\$96.80	\$77.44	.79	.56	.743
7/8" OD X .083"	3/8-24	C73-871-2	\$12.10	\$9.68	\$7.74	C73-871-20	\$96.80	\$77.44	.79	.56	.707
7/8" OD X .083"	7/16-20	C73-873-2	\$12.10	\$9.68	\$7.74	C73-873-20	\$96.80	\$77.44	.79	.56	.707
7/8" OD X .083"	1/2-20	C73-875-2	\$12.10	\$9.68	\$7.74	C73-875-20	\$96.80	\$77.44	.79	.56	.707
1" OD X .058"	3/8-24	C73-885-2	\$12.60	\$10.08	\$8.06	C73-885-20	\$100.80	\$80.64	.92	.78	.882
1" OD X .058"	7/16-20	C73-887-2	\$12.60	\$10.08	\$8.06	C73-887-20	\$100.80	\$80.64	.92	.78	.882
1" OD X .058"	1/2-20	C73-889-2	\$12.60	\$10.08	\$8.06	C73-889-20	\$100.80	\$80.64	.92	.78	.882
1" OD X .058"	5/8-18	C73-891-2	\$12.60	\$10.08	\$8.06	C73-891-20	\$100.80	\$80.64	.92	.78	.882
1" OD X .065"	3/8-24	C73-893-2	\$12.60	\$10.08	\$8.06	C73-893-20	\$100.80	\$80.64	.92	.78	.868
1" OD X .065"	7/16-20	C73-895-2	\$12.60	\$10.08	\$8.06	C73-895-20	\$100.80	\$80.64	.92	.78	.868
1" OD X .065"	1/2-20	C73-897-2	\$12.60	\$10.08	\$8.06	C73-897-20	\$100.80	\$80.64	.92	.78	.868
1" OD X .065"	5/8-18	C73-899-2	\$12.60	\$10.08	\$8.06	C73-899-20	\$100.80	\$80.64	.92	.78	.868
1" OD X .083"	7/16-20	C73-903-2	\$12.60	\$10.08	\$8.06	C73-903-20	\$100.80	\$80.64	.92	.78	.832
1" OD X .083"	1/2-20	C73-905-2	\$12.60	\$10.08	\$8.06	C73-905-20	\$100.80	\$80.64	.92	.78	.832
1" OD X .083"	5/8-18	C73-907-2	\$12.60	\$10.08	\$8.06	C73-907-20	\$100.80	\$80.64	.92	.78	.832
1-1/8" OD X .058"	1/2-20	C73-917-2	\$14.30	\$11.44	\$9.15	C73-917-20	\$114.40	\$91.52	1.0	.75	1.007
1-1/8" OD X .058"	5/8-18	C73-919-2	\$14.30	\$11.44	\$9.15	C73-919-20	\$114.40	\$91.52	1.0	.75	1.007
1-1/8" OD X .065"	1/2-20	C73-923-2	\$14.30	\$11.44	\$9.15	C73-923-20	\$114.40	\$91.52	1.0	.75	.993
1-1/8" OD X .065"	5/8-18	C73-925-2	\$14.30	\$11.44	\$9.15	C73-925-20	\$114.40	\$91.52	1.0	.75	.993
1-1/8" OD X .065"	3/4-16	C73-927-2	\$14.30	\$11.44	\$9.15	C73-927-20	\$114.40	\$91.52	1.0	.75	.993
1-1/8" OD X .083"	1/2-20	C73-929-2	\$14.30	\$11.44	\$9.15	C73-929-20	\$114.40	\$91.52	1.0	.75	.957
1-1/8" OD X .083"	5/8-18	C73-931-2	\$14.30	\$11.44	\$9.15	C73-931-20	\$114.40	\$91.52	1.0	.75	.957
1-1/8" OD X .083"	3/4-16	C73-933-2	\$14.30	\$11.44	\$9.15	C73-933-20	\$114.40	\$91.52	1.0	.75	.957
1-1/4" OD X .095"	5/8-18	C73-941-2	\$16.20	\$12.96	\$10.37	C73-941-20	\$129.60	\$103.68	1.0	.75	1.058
1-1/4" OD X .095"	3/4-16	C73-943-2	\$16.20	\$12.96	\$10.37	C73-943-20	\$129.60	\$103.68	1.0	.75	1.058
1-1/4" OD X .120"	5/8-18	C73-945-2	\$16.20	\$12.96	\$10.37	C73-945-20	\$129.60	\$103.68	1.0	.75	1.008
1-1/4" OD X .120"	3/4-16	Hex Only									
1-3/8" OD X .095"	5/8-18	C73-949-2	\$16.90	\$13.52	\$10.82	C73-949-20	\$135.20	\$108.16	1.12	.75	1.183
1-3/8" OD X .095"	3/4-16	Hex Only									
1-3/8" OD X .120"	7/8-14	C78-101-2	\$16.90	\$13.52	\$10.82	C78-101-20	\$135.20	\$108.16	1.12	.75	1.133
1-1/2" OD X .120"	7/8-14	C78-105-2	\$29.00	\$23.20	\$18.56	C78-105-20	\$232.00	\$185.60	1.12	.75	1.258
1-3/4" OD X .120"	1 1/4-12	C78-113-2	\$33.50	\$26.80	\$21.44	C78-113-20	\$268.00	\$214.40	1.12	.75	1.508



ROUND TUBE ADAPTOR

HEX TUBE ADAPTOR

LEFT HAND HEX TUBE ADAPTERS

FITS TUBE SIZE	THREAD SIZE	PACK OF (2)	DISCOUNT PRICE PER PACK			BAG OF (20)	DISCOUNT PRICE PER BAG		DIAGRAM PAGE 10		
			1-9	10-19	20+		(1) BAG	(2) BAGS	A	B	C
3/4" OD X .058"	3/8-24	C73-837-H-2	\$13.90	\$11.12	\$8.90	C73-837-H-20	\$111.20	\$88.96	.925	.525	.632
7/8" OD X .058"	3/8-24	C73-859-H-2	\$15.20	\$12.16	\$9.73	C73-859-H-20	\$121.60	\$97.28	1.26	.525	.757
7/8" OD X .058"	7/16-20	C73-861-H-2	\$15.20	\$12.16	\$9.73	C73-861-H-20	\$121.60	\$97.28	1.26	.525	.757
7/8" OD X .058"	1/2-20	C73-863-H-2	\$15.20	\$12.16	\$9.73	C73-863-H-20	\$121.60	\$97.28	1.26	.525	.757
1" OD X .058"	1/2-20	C73-889-H-2	\$15.84	\$12.67	\$10.14	C73-889-H-20	\$126.72	\$101.38	1.30	.775	.882
1-1/4" OD X .095"	3/4-16	C73-943-H-2	\$18.60	\$14.88	\$11.90	C73-943-H-20	\$148.80	\$119.04	1.375	.75	1.058
1-1/4" OD X .120"	3/4-16	C73-947-H-2	\$18.60	\$14.88	\$11.90	C73-947-H-20	\$148.80	\$119.04	1.375	.75	1.008
1-3/8" OD X .095"	3/4-16	C73-951-H-2	\$18.60	\$14.88	\$11.90	C73-951-H-20	\$148.80	\$119.04	1.375	.75	1.183

RIGHT HAND ROUND TUBE ADAPTERS

These weld-in threaded tube adapters are perfect for construction of linkage and suspension components. Adapters are CNC machined 4130 chromoly to precise tolerances with a jewelry quality finish.

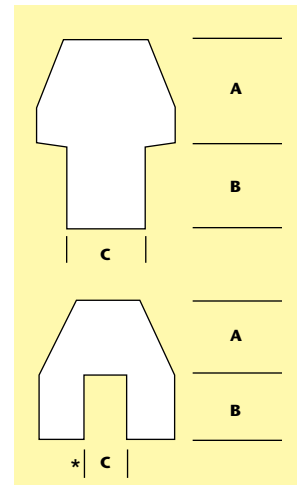

RIGHT HAND ROUND TUBE ADAPTERS

FITS TUBE SIZE	THREAD SIZE	PACK OF (2)	DISCOUNT PRICE PER PACK			BAG OF (20)	DISCOUNT PRICE PER BAG			A	B	C
			1-9	10-19	20+		(1) BAG	(2) BAGS				
*5/16" OD	10-32	C73-800-2	\$10.54	\$8.43	\$6.75	C73-800-20	\$84.32	\$67.45	.510	.415	.320	
*3/8" OD	10-32	C73-806-2	\$10.54	\$8.43	\$6.75	C73-806-20	\$84.32	\$67.45	.510	.415	.380	
1/2" OD X .058"	1/4-28	C73-812-2	\$10.54	\$8.43	\$6.75	C73-812-20	\$84.32	\$67.45	.510	.415	.382	
5/8" OD X .058"	5/16-24	C73-818-2	\$10.54	\$8.43	\$6.75	C73-818-20	\$84.32	\$67.45	.510	.415	.507	
5/8" OD X .058"	3/8-24	C73-820-2	\$10.54	\$8.43	\$6.75	C73-820-20	\$84.32	\$67.45	.510	.415	.507	
3/4" OD X .058"	5/16-24	C73-834-2	\$11.00	\$8.80	\$7.04	C73-834-20	\$88.00	\$70.40	.65	.55	.632	
3/4" OD X .058"	3/8-24	C73-836-2	\$11.00	\$8.80	\$7.04	C73-836-20	\$88.00	\$70.40	.65	.55	.632	
3/4" OD X .058"	7/16-20	C73-838-2	\$11.00	\$8.80	\$7.04	C73-838-20	\$88.00	\$70.40	.65	.55	.632	
3/4" OD X .065"	5/16-24	C73-840-2	\$11.00	\$8.80	\$7.04	C73-840-20	\$88.00	\$70.40	.65	.55	.618	
3/4" OD X .065"	3/8-24	C73-842-2	\$11.00	\$8.80	\$7.04	C73-842-20	\$88.00	\$70.40	.65	.55	.618	
3/4" OD X .065"	7/16-20	C73-844-2	\$11.00	\$8.80	\$7.04	C73-844-20	\$88.00	\$70.40	.65	.55	.618	
7/8" OD X .058"	3/8-24	C73-858-2	\$12.10	\$9.68	\$7.74	C73-858-20	\$96.80	\$77.44	.79	.56	.757	
7/8" OD X .058"	7/16-20	C73-860-2	\$12.10	\$9.68	\$7.74	C73-860-20	\$96.80	\$77.44	.79	.56	.757	
7/8" OD X .058"	1/2-20	C73-862-2	\$12.10	\$9.68	\$7.74	C73-862-20	\$96.80	\$77.44	.79	.56	.757	
7/8" OD X .065"	3/8-24	C73-864-2	\$12.10	\$9.68	\$7.74	C73-864-20	\$96.80	\$77.44	.79	.56	.743	
7/8" OD X .065"	7/16-20	C73-866-2	\$12.10	\$9.68	\$7.74	C73-866-20	\$96.80	\$77.44	.79	.56	.743	
7/8" OD X .065"	1/2-20	C73-868-2	\$12.10	\$9.68	\$7.74	C73-868-20	\$96.80	\$77.44	.79	.56	.743	
7/8" OD X .083"	3/8-24	C73-870-2	\$12.10	\$9.68	\$7.74	C73-870-20	\$96.80	\$77.44	.79	.56	.707	
7/8" OD X .083"	7/16-20	C73-872-2	\$12.10	\$9.68	\$7.74	C73-872-20	\$96.80	\$77.44	.79	.56	.707	
7/8" OD X .083"	1/2-20	C73-874-2	\$12.10	\$9.68	\$7.74	C73-874-20	\$96.80	\$77.44	.79	.56	.707	
1" OD X .058"	3/8-24	C73-884-2	\$12.60	\$10.08	\$8.06	C73-884-20	\$100.80	\$80.64	.92	.78	.882	
1" OD X .058"	7/16-20	C73-886-2	\$12.60	\$10.08	\$8.06	C73-886-20	\$100.80	\$80.64	.92	.78	.882	
1" OD X .058"	1/2-20	C73-888-2	\$12.60	\$10.08	\$8.06	C73-888-20	\$100.80	\$80.64	.92	.78	.882	
1" OD X .058"	5/8-18	C73-890-2	\$12.60	\$10.08	\$8.06	C73-890-20	\$100.80	\$80.64	.92	.78	.882	
1" OD X .065"	3/8-24	C73-892-2	\$12.60	\$10.08	\$8.06	C73-892-20	\$100.80	\$80.64	.92	.78	.868	
1" OD X .065"	7/16-20	C73-894-2	\$12.60	\$10.08	\$8.06	C73-894-20	\$100.80	\$80.64	.92	.78	.868	
1" OD X .065"	1/2-20	C73-896-2	\$12.60	\$10.08	\$8.06	C73-896-20	\$100.80	\$80.64	.92	.78	.868	
1" OD X .065"	5/8-18	C73-898-2	\$12.60	\$10.08	\$8.06	C73-898-20	\$100.80	\$80.64	.92	.78	.868	
1" OD X .083"	7/16-20	C73-902-2	\$12.60	\$10.08	\$8.06	C73-902-20	\$100.80	\$80.64	.92	.78	.832	
1" OD X .083"	1/2-20	C73-904-2	\$12.60	\$10.08	\$8.06	C73-904-20	\$100.80	\$80.64	.92	.78	.832	
1" OD X .083"	5/8-18	C73-906-2	\$12.60	\$10.08	\$8.06	C73-906-20	\$100.80	\$80.64	.92	.78	.832	
1-1/8" OD X .058"	1/2-20	C73-916-2	\$14.30	\$11.44	\$9.15	C73-916-20	\$114.40	\$91.52	1.0	.75	1.007	
1-1/8" OD X .058"	5/8-18	C73-918-2	\$14.30	\$11.44	\$9.15	C73-918-20	\$114.40	\$91.52	1.0	.75	1.007	
1-1/8" OD X .065"	1/2-20	C73-922-2	\$14.30	\$11.44	\$9.15	C73-922-20	\$114.40	\$91.52	1.0	.75	.993	
1-1/8" OD X .065"	5/8-18	C73-924-2	\$14.30	\$11.44	\$9.15	C73-924-20	\$114.40	\$91.52	1.0	.75	.993	
1-1/8" OD X .065"	3/4-16	C73-926-2	\$14.30	\$11.44	\$9.15	C73-926-20	\$114.40	\$91.52	1.0	.75	.993	
1-1/8" OD X .083"	1/2-20	C73-928-2	\$14.30	\$11.44	\$9.15	C73-928-20	\$114.40	\$91.52	1.0	.75	.957	
1-1/8" OD X .083"	5/8-18	C73-930-2	\$14.30	\$11.44	\$9.15	C73-930-20	\$114.40	\$91.52	1.0	.75	.957	
1-1/8" OD X .083"	3/4-16	C73-932-2	\$14.30	\$11.44	\$9.15	C73-932-20	\$114.40	\$91.52	1.0	.75	.957	
1-1/4" OD X .095"	5/8-18	C73-940-2	\$16.20	\$12.96	\$10.37	C73-940-20	\$129.60	\$103.68	1.0	.75	1.058	
1-1/4" OD X .095"	3/4-16	C73-942-2	\$16.20	\$12.96	\$10.37	C73-942-20	\$129.60	\$103.68	1.0	.75	1.058	
1-1/4" OD X .120"	5/8-18	C73-944-2	\$16.20	\$12.96	\$10.37	C73-944-20	\$129.60	\$103.68	1.0	.75	1.008	
1-1/4" OD X .120"	3/4-16	C73-946-2	\$16.20	\$12.96	\$10.37	C73-946-20	\$129.60	\$103.68	1.0	.75	1.008	
1-3/8" OD X .095"	5/8-18	C73-948-2	\$16.90	\$13.52	\$10.82	C73-948-20	\$135.20	\$108.16	1.12	.75	1.183	
1-3/8" OD X .095"	3/4-16	C73-950-2	\$16.90	\$13.52	\$10.82	C73-950-20	\$135.20	\$108.16	1.12	.75	1.183	
1-3/8" OD X .120"	7/8-14	C78-100-2	\$16.90	\$13.52	\$10.82	C78-100-20	\$135.20	\$108.16	1.12	.75	1.133	
1-1/2" OD X .120"	7/8-14	C78-104-2	\$29.00	\$23.20	\$18.56	C78-104-20	\$232.00	\$185.60	1.12	.75	1.258	
1-3/4" OD X .120"	1 1/4-12	C78-112-2	\$33.50	\$26.80	\$21.44	C78-112-20	\$268.00	\$214.40	1.313	.75	1.508	

Our large selection of right and left hand weld-in threaded tube adapters prove to be a great time saver by simplifying linkage construction. Over 100 size and thread combinations are available to choose from. Additional savings can be earned through the quantity discounts listed.

NYLOCK NUTS

Plated steel grade 5, with nylon insert provides a right hand UNF thread friction grip.



Half Height

HALF HEIGHT		
PACK OF (6)	DESCRIPTION	PRICE
C73-032	1/4-28	\$3.50
C73-034	5/16-24	\$3.95
C73-036	3/8-24	\$4.25
C73-038	7/16-20	\$4.50
C73-040	1/2-20	\$4.65

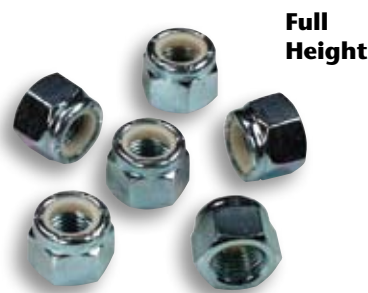

Full Height

FULL HEIGHT		
PACK OF (6)	DESCRIPTION	PRICE
C73-031	10-32	\$3.25
C73-033	1/4-28	\$3.50
C73-035	5/16-24	\$3.95
C73-037	3/8-24	\$4.25
C73-039	7/16-20	\$4.50
C73-041	1/2-20	\$4.65

PACK OF (4)	DESCRIPTION	PRICE
C73-043	5/8-18	\$5.65
C73-045	3/4-16	\$6.75

JAM NUTS

Plated steel grade 5 jam nuts provide a positive lock on final adjustments.



LEFT HAND		
PACK OF (6)	DESCRIPTION	PRICE
C73-053	1/4-28	\$4.65
C73-055	5/16-24	\$5.65
C73-057	3/8-24	\$6.35
C73-059	7/16-20	\$6.75
C73-061	1/2-20	\$6.75

RIGHT HAND		
PACK OF (6)	DESCRIPTION	PRICE
C73-050	10-32	\$3.25
C73-052	1/4-28	\$3.50
C73-054	5/16-24	\$4.25
C73-056	3/8-24	\$4.65
C73-058	7/16-20	\$5.25
C73-060	1/2-20	\$5.65

LEFT HAND		
PACK OF (4)	DESCRIPTION	PRICE
C73-063	5/8-18	\$6.75
C73-065	3/4-16	\$9.95

RIGHT HAND		
PACK OF (4)	DESCRIPTION	PRICE
C73-062	5/8-18	\$5.65
C73-064	3/4-16	\$7.50

AN WASHERS

Small outside diameter flat washers are cadmium plated steel. Washers measure .063" thick.

PACK OF (100)	SIZE	I.D.	O.D.	PRICE
C73-010	3/16"	.203"	.438"	\$8.95
C73-011	1/4"	.265"	.500"	\$8.95
C73-012	5/16"	.328"	.562"	\$8.95
C73-013	3/8"	.390"	.625"	\$10.95
C73-014	7/16"	.453"	.750"	\$12.95
C73-015	1/2"	.515"	.875"	\$19.95



TWO PIECE "C" SERIES (MILD STEEL)

The "C" Series consists of a low carbon steel body (zinc plated) and precision ground oil impregnated sintered steel ball. This construction allows the rod end body to carry a greater static load and offers greater misalignment capabilities.



Buy 10 Aurora Rod Ends and SAVE an additional 10% off retail price, mix & match.

MALE



HOLE DIA.	THREAD SIZE	BALL WIDTH	DEGREE OF MISALIGNMENT	RADIAL LOAD CAPACITY (LBS)	PART #	LEFT HAND		RIGHT HAND		
						1-9	10+	1-9	10+	10+
3/16"	10-32	.312	17	1,204	CB3	\$5.28	\$4.75	CM3	\$5.08	\$4.57
1/4"	1/4-28	.375	21	2,212	CB4	\$5.42	\$4.88	CM4	\$5.22	\$4.70
5/16"	5/16-24	.437	17	3,577	CB5	\$5.94	\$5.35	CM5	\$5.74	\$5.17
3/8"	3/8-24	.500	19	5,068	CB6	\$6.74	\$6.07	CM6	\$6.54	\$5.89
7/16"	7/16-20	.562	18	6,345	CB7	\$7.94	\$7.15	CM7	\$7.74	\$6.97
1/2"	1/2-20	.625	17	8,338	CB8	\$10.70	\$9.63	CM8	\$10.50	\$9.45
5/8"	5/8-18	.750	22	9,713	CB10	\$13.09	\$11.78	CM10	\$12.91	\$11.62
3/4"	3/4-16	.875	18	14,207	CB12	\$17.84	\$16.06	CM12	\$17.66	\$15.89

FEMALE



HOLE DIA.	THREAD SIZE	BALL WIDTH	DEGREE OF MISALIGNMENT	RADIAL LOAD CAPACITY (LBS)	PART #	LEFT HAND		RIGHT HAND		
						1-9	10+	1-9	10+	10+
3/16"	10-32	.312	17	2,079	CG3	\$5.08	\$4.57	CW3	\$4.88	\$4.39
1/4"	1/4-28	.375	21	3,208	CG4	\$5.26	\$4.73	CW4	\$5.06	\$4.55
5/16"	5/16-24	.437	17	3,824	CG5	\$5.32	\$4.79	CW5	\$5.12	\$4.61
3/8"	3/8-24	.500	19	5,087	CG6	\$6.32	\$5.69	CW6	\$6.12	\$5.51
7/16"	7/16-20	.562	18	6,385	CG7	\$7.96	\$7.16	CW7	\$7.76	\$6.98
1/2"	1/2-20	.625	17	9,096	CG8	\$10.68	\$9.61	CW8	\$10.48	\$9.43
5/8"	5/8-18	.750	22	9,713	CG10	\$13.34	\$12.01	CW10	\$13.16	\$11.84
3/4"	3/4-16	.875	18	14,207	CG12	\$17.93	\$16.14	CW12	\$17.75	\$15.98

TECH TIP

RADIAL STATIC LOAD CAPACITY?
 These loads are based upon the minimal mechanical properties of the design configuration of the stressed areas. The Operation Load Capacity of Aurora rod ends is based upon the Radial Static Load Rating. Appropriate safety factors should be utilized with the application. Full rotation assemblies up to 100 rpm should not exceed 10% of the radial static load.

AXIAL LOAD CAPACITY?
 Axial static load is the force that is applied through the bore of the ball. Maximum axial static load capacity is recommended at 15% of the radial static load for Aurora two piece rod ends, 10% for three piece rod ends.

BEARING MISALIGNMENT?
 A rod end or spherical bearings ability to misalign is measured by the degree of angle the ball can accommodate without interference.

ROD ENDS

THREE PIECE "A" SERIES (CHROMOLY)

The "A" series consists of a body, ball and race. This type of construction allows for the use of different metals for each component part. The body is manufactured out of 4130 steel alloy, which is heat treated, cadmium plated and chromate treated. Specifications for the race are heat treated alloy steel, zinc plated, and chromate treated materials. The ball is made from 52100 steel (AMS-7440) and is heat treated, and hard chrome plated.



HOLE DIA.	THREAD SIZE	BALL WIDTH	DEGREE OF MISALIGNMENT	RADIAL LOAD CAPACITY (LBS)	PART #	LEFT HAND		RIGHT HAND		
						1-9	10+	PART #	1-9	10+
3/16"	10-32	.312	17	2,851	AB3	\$17.64	\$15.88	AM3	\$17.44	\$15.70
1/4"	1/4-28	.375	21	5,260	AB4	\$17.66	\$15.89	AM4	\$17.46	\$15.71
5/16"	5/16-24	.437	17	7,639	AB5	\$17.94	\$16.15	AM5	\$17.74	\$15.97
3/8"	3/8-24	.500	19	9,544	AB6	\$20.88	\$18.79	AM6	\$20.68	\$18.61
7/16"	7/16-20	.562	18	10,285	AB7	\$25.66	\$23.09	AM7	\$25.46	\$22.91
1/2"	1/2-20	.625	17	16,238	AB8	\$31.02	\$27.92	AM8	\$30.82	\$27.74
5/8"	5/8-18	.750	22	17,955	AB10	\$37.42	\$33.68	AM10	\$37.24	\$33.52
3/4"	3/4-16	.875	18	28,081	AB12	\$53.32	\$47.99	AM12	\$53.14	\$47.83

TEFLON LINED

HOLE DIA.	THREAD SIZE	BALL WIDTH	DEGREE OF MISALIGNMENT	RADIAL LOAD CAPACITY (LBS)	PART #	LEFT HAND		RIGHT HAND		
						1-9	10+	PART #	1-9	10+
3/8"	3/8-24	.500	19	9,544	AB6-T	\$24.34	\$21.91	AM6-T	\$24.14	\$21.73
7/16"	7/16-20	.562	18	10,285	AB7-T	\$29.12	\$26.21	AM7-T	\$28.92	\$26.03
1/2"	1/2-20	.625	17	16,238	AB8-T	\$34.48	\$31.03	AM8-T	\$34.92	\$30.85
5/8"	5/8-18	.750	22	17,955	AB10-T	\$40.54	\$36.49	AM10-T	\$40.36	\$36.32
3/4"	3/4-16	.875	18	28,081	AB12-T	\$56.43	\$50.79	AM12-T	\$52.25	\$50.63
7/8"	7/8-14	.875	12	55,692	*AB14-T-70	\$118.09	\$106.28	*AM14-T-70	\$118.09	\$106.28

*Features special heat treated race



EXTRA HEAVY DUTY "XA" SERIES (CHROMOLY)

The "XA" Series rod ends feature large body and threaded shank with a standard size ball. Three piece construction, with body, ball and race. Materials used in the construction of the "XA" Series are the same as the "A" Series.



HOLE DIA.	THREAD SIZE	BALL WIDTH	DEGREE OF MISALIGNMENT	RADIAL LOAD CAPACITY (LBS)	PART #	LEFT HAND		RIGHT HAND		
						1-9	10+	PART #	1-9	10+
3/16"	1/4-28	.312	10	5,260	XAB3	\$17.60	\$15.84	XAM3	\$17.40	\$15.66
1/4"	5/16-24	.375	13	8,452	XAB4	\$18.00	\$16.20	XAM4	\$17.80	\$16.02
5/16"	3/8-24	.437	12	12,978	XAB5	\$20.92	\$18.83	XAM5	\$20.72	\$18.65
3/8"	7/16-20	.500	10	17,508	XAB6	\$25.84	\$23.26	XAM6	\$25.64	\$23.08
7/16"	1/2-20	.562	12	23,452	XAB7	\$31.14	\$28.03	XAM7	\$30.94	\$27.85
1/2"	5/8-18	.625	10	31,390	XAB8	\$41.48	\$37.33	XAM8	\$41.28	\$37.15
5/8"	3/4-16	.750	13	40,572	XAB10	\$53.26	\$47.93	XAM10	\$53.08	\$47.77

TEFLON LINED

HOLE DIA.	THREAD SIZE	BALL WIDTH	DEGREE OF MISALIGNMENT	RADIAL LOAD CAPACITY (LBS)	PART #	LEFT HAND		RIGHT HAND		
						1-9	10+	PART #	1-9	10+
1/2"	3/4-16	.750	13	40,572	XAB8-T-2	\$69.02	\$69.02	XAM8-T-2	\$69.02	\$69.02
1/2"	5/8-18	.625	10	31,390	XAB8-T	\$44.94	\$40.45	XAM8-T	\$44.74	\$40.27
5/8"	3/4-16	.750	13	40,572	XAB10-T	\$56.38	\$50.74	XAM10-T	\$56.20	\$50.58
1"	1-1/4-12	1.375	17	76,200	*RAB16-T-3	\$134.19	\$120.77	*RAM16-T-3	\$134.19	\$120.77

* Features special heat treated race



HIGH MISALIGNMENT SERIES (CHROMOLY)

These special high misalignment rod ends are based on the "XA" series. Assembled with a special ball that includes built in shoulders, providing additional misalignment without the use of spacers. The durable Teflon liner provides additional wear resistance.



HOLE DIA.	THREAD SIZE	BALL WIDTH	DEGREE OF MISALIGNMENT	RADIAL LOAD CAPACITY (LBS)	PART #	LEFT HAND		RIGHT HAND		
						1-9	10+	PART #	1-9	10+
5/16"	7/16-20	.813	22	11,781	HXAB5-T	\$56.47	\$50.82	HXAM5-T	\$56.47	\$50.82
3/8"	7/16-20	.813	22	11,781	HXAB6-T	\$51.57	\$46.41	HXAM6-T	\$51.57	\$46.41
7/16"	1/2-20	.875	21	17,105	HXAB7-T	\$62.06	\$55.85	HXAM7-T	\$62.06	\$55.85
1/2"	5/8-18	.937	19	23,720	HXAB8-T	\$76.77	\$69.09	HXAM8-T	\$76.77	\$69.09
5/8"	3/4-16	1.200	19	32,067	HXAB10-T	\$97.34	\$87.61	HXAM10-T	\$97.34	\$87.61

TECH TIP

PTFE LINER?

The military spec Teflon race greatly increases dynamic wear characteristics, making this the ideal choice for 4-links and ladder bars. This PTFE lined option is not to be confused with other rod end manufacturers' soft Nylon races.

ROD END INSERT

Perfect for shock end bearings and components that don't need adjustability.



PART #	I.D.	O.D.	1-9	10+
COM8	1/2"	1"	\$11.18	\$10.06
COM10	5/8"	1-3/16"	\$11.52	\$10.37
COM12	3/4"	1-7/16"	\$17.10	\$15.39

TEFLON LINED

PART #	I.D.	O.D.	1-9	10+
COM8-T	1/2"	1"	\$15.56	\$14.00
COM10-T	5/8"	1-3/16"	\$16.48	\$14.83
COM12-T	3/4"	1-7/16"	\$22.06	\$19.85

HIGH MISALIGNMENT BUSHINGS

These 304 stainless steel bushings double as a spacer and increase the misalignment capabilities of rod ends. Using bushing reduces size of ball hole. Will not fit "Com" series rod end inserts.

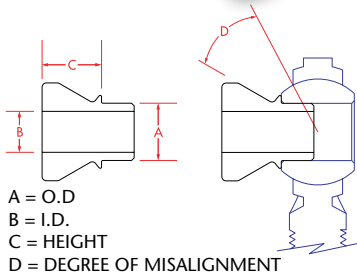

PACK OF (2)	O.D.	I.D.	HEIGHT	DEGREE OF MISALIGNMENT	PRICE	BAG OF (20)	1 BAG
C78-010-2	5/8"	1/2"	1/4"	25	\$20.72	C78-010-20	\$186.48
C78-011-2	3/4"	1/2"	1/4"	25	\$20.72	C78-011-20	\$186.48
C78-012-2	3/4"	1/2"	1/2"	25	\$20.72	C78-012-20	\$186.48
C78-016-2	3/4"	5/8"	1/2"	22	\$20.72	C78-016-20	\$186.48
C78-013-2	7/8"	5/8"	5/8"	21	\$23.04	C78-013-20	\$207.36
C78-014-2	1"	5/8"	3/4"	33	\$24.08	C78-014-20	\$216.72
C78-015-2	1"	3/4"	3/4"	28	\$24.08	C78-015-20	\$216.72

STEERING SHAFT SUPPORT

This 3/4-16 RH threaded rod end has a special .005" oversized hole in the ball allowing it to easily accept a 3/4" dia. steering shaft.



PART #	I.D.	1-9	10+
CM12-12	.755"	\$23.89	\$21.50

SAFETY WASHERS

Precision-machined mild steel is gold zinc-plated for long lasting corrosion resistance. Radius under cut design allows for increased rod end misalignment angle

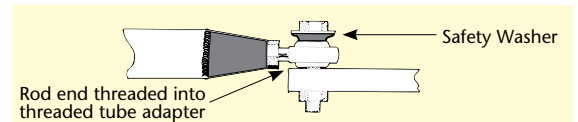

PACK OF (2)	I.D.	O.D.	THICKNESS	PRICE	BAG OF (20)	1 BAG
C73-463-2	5/16"	7/8"	.170"	\$5.80	C73-463-20	\$52.20
C73-464-2	3/8"	1"	.200"	\$5.80	C73-464-20	\$52.20
C73-465-2	7/16"	1-1/8"	.220"	\$5.80	C73-465-20	\$52.20
C73-466-2	1/2"	1-1/4"	.220"	\$5.80	C73-466-20	\$52.20
C73-467-2	5/8"	1-3/8"	.250"	\$5.80	C73-467-20	\$52.20
C73-468-2	3/4"	1-5/8"	.330"	\$5.80	C73-468-20	\$52.20

SEALS IT WASHERS

Extends rod end life by sealing out dust and foreign debris. Fits any style of rod end. All sizes are .063" thick.



PACK OF (2)	ROD END	PRICE
C73-473-2	5/16	\$5.60
C73-474-2	3/8	\$5.60
C73-475-2	7/16	\$5.60
C73-476-2	1/2	\$5.60
C73-477-2	5/8	\$5.60
C73-478-2	3/4	\$6.60



MILD STEEL BRACKETS

Our large selection of quality die stamped mild steel tabs will save you time and money! No more cutting or filing; we've got a tab for every need...and at an affordable price.

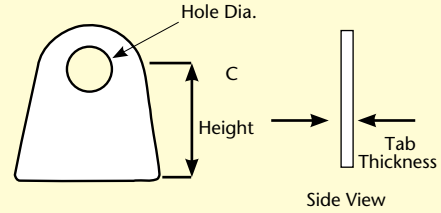

MILD STEEL FLAT TABS



PACK OF (10)	HOLE DIA.	THICKNESS	HEIGHT	DISCOUNT PRICE PER PACK			BAG OF (20)	1 BAG	2 BAGS	3 BAGS
				1-3	4-5	6+				
C73-095-10	1/4"	1/8"	7/8"	\$13.00	\$11.70	\$11.05	C73-095-20	\$26.00	\$23.40	\$22.10
C73-096-10	1/4"	1/8"	15/16"	\$21.40	\$19.26	\$18.19	C73-096-20	\$42.80	\$38.52	\$36.38
C73-101-10	3/16"	1/16"	1/2"	\$8.60	\$7.74	\$7.31	C73-101-20	\$17.20	\$15.48	\$14.62
C73-102-10	3/16"	1/16"	3/4"	\$8.80	\$7.92	\$7.48	C73-102-20	\$17.60	\$15.84	\$14.96
C73-103-10	1/4"	3/32"	15/16"	\$6.60	\$5.94	\$5.61	C73-103-20	\$13.20	\$11.88	\$11.22
C73-107-10	3/16"	1/8"	3/4"	\$5.10	\$4.59	\$4.34	C73-107-20	\$10.20	\$9.18	\$8.67
C73-109-10	1/4"	3/32"	7/8"	\$6.60	\$5.94	\$5.61	C73-109-20	\$13.20	\$11.88	\$11.22
C73-110-10	3/8"	3/32"	7/8"	\$6.60	\$5.94	\$5.61	C73-110-20	\$13.20	\$11.88	\$11.22
C73-111-10	1/2"	3/16"	7/8"	\$7.20	\$6.48	\$6.12	C73-111-20	\$14.40	\$12.96	\$12.24
C73-112-10	1/2"	1/4"	7/8"	\$6.60	\$5.94	\$5.61	C73-112-20	\$13.20	\$11.88	\$11.22
C73-131-10	1/4"	1/16"	11/16"	\$10.60	\$9.54	\$9.01	C73-131-20	\$21.20	\$19.08	\$18.02

PACK OF (4)	HOLE DIA.	THICKNESS	HEIGHT	DISCOUNT PRICE PER PACK			BAG OF (20)	1 BAG	2 BAGS	3 BAGS
				1-9	10-14	15+				
C73-098-4	1/4"	1/8"	11/16"	\$6.96	\$6.26	\$5.92	C73-098-20	\$34.80	\$31.32	\$29.58
C73-099-4	5/16"	3/16"	11/16"	\$7.12	\$6.41	\$6.05	C73-099-20	\$35.60	\$32.04	\$30.26
C73-104-4	5/8"	3/32"	3/4"	\$7.44	\$6.70	\$6.32	C73-104-20	\$37.20	\$33.48	\$31.62
C73-105-4	1-3/16"	1/8"	1-3/8"	\$7.92	\$7.13	\$6.73	C73-105-20	\$39.60	\$35.64	\$33.66
C73-106-4	1/4"	1/8"	3"	\$8.16	\$7.34	\$6.94	C73-106-20	\$40.80	\$36.72	\$34.68
C73-108-4	1/4"	3/32"	1"	\$8.80	\$4.61	\$4.35	C73-108-20	\$44.00	\$39.60	\$37.40
C73-113-4	1/2"	3/16"	1-3/16"	\$11.20	\$10.08	\$9.52	C73-113-20	\$56.00	\$50.40	\$47.60
C73-114-4	3/8"	1/8"	1-3/16"	\$10.16	\$9.14	\$8.64	C73-114-20	\$50.80	\$45.72	\$43.18
C73-115-4	3/8"	3/16"	7/8"	\$8.64	\$7.78	\$7.34	C73-115-20	\$43.20	\$38.88	\$36.72
C73-116-4	1/2"	3/16"	1-5/16"	\$9.36	\$8.42	\$7.96	C73-116-20	\$46.80	\$42.12	\$39.78
C73-117-4	1/2"	1/4"	1-3/8"	\$12.08	\$10.87	\$10.27	C73-117-20	\$60.40	\$54.36	\$51.34
C73-132-4	1/2"	3/16"	1"	\$11.04	\$9.94	\$9.38	C73-132-20	\$55.20	\$49.68	\$46.92
C73-185-4	1/2"	1/8"	1-5/16"	\$8.80	\$7.92	\$7.48	C73-185-20	\$44.00	\$39.60	\$37.40
C73-187-4	3/4"	1/4"	1-3/8"	\$12.08	\$10.87	\$10.27	C73-187-20	\$60.40	\$54.36	\$51.34

MILD STEEL RADIUS TABS

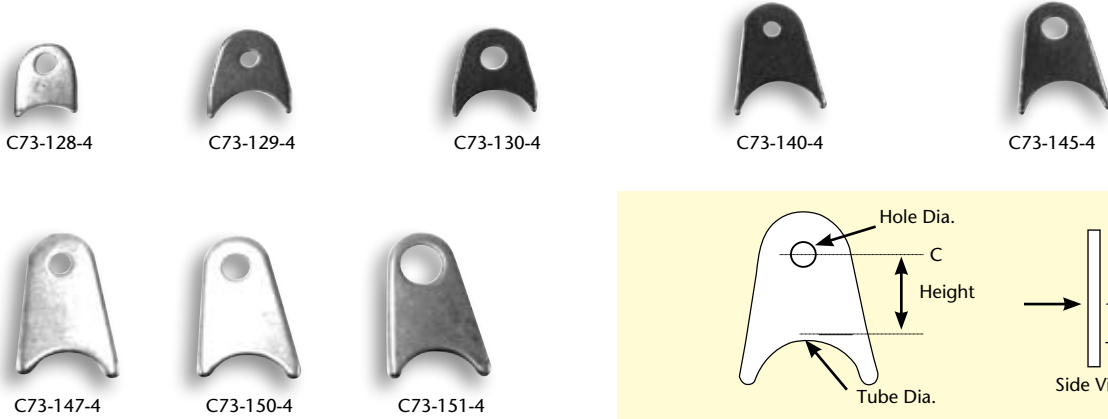

PACK OF (4)	HOLE DIA.	THICKNESS	HEIGHT	TUBE DIA.	DISCOUNT PRICE PER PACK			BAG OF (20)	1 BAG	2 BAGS	3 BAGS
					1-9	10-14	15+				
C73-128-4	5/16"	1/8"	3/4"	1-1/2"	\$5.68	\$5.11	\$4.88	C73-128-20	\$28.40	\$25.56	\$24.14
C73-129-4	1/4"	1/8"	9/16"	1-1/4"	\$5.76	\$5.18	\$4.90	C73-129-20	\$28.80	\$25.92	\$24.48
C73-130-4	3/8"	1/8"	9/16"	1-1/4"	\$5.76	\$5.18	\$4.90	C73-130-20	\$28.80	\$25.92	\$24.48
C73-140-4	1/4"	1/8"	15/16"	1-1/4"	\$8.80	\$7.92	\$7.48	C73-140-20	\$44.00	\$39.60	\$37.40
C73-145-4	3/8"	3/16"	1-3/4"	1-5/8"	\$12.08	\$10.87	\$10.27	C73-145-20	\$60.40	\$54.36	\$51.34
C73-147-4	3/4"	3/16"	1-3/4"	1-5/8"	\$14.72	\$13.25	\$12.51	C73-147-20	\$73.60	\$66.24	\$62.56
C73-150-4	3/8"	1/8"	15/16"	1-1/4"	\$10.80	\$9.72	\$9.18	C73-150-20	\$54.00	\$48.60	\$45.90
C73-151-4	1/2"	3/16"	1-3/4"	1-5/8"	\$12.08	\$10.87	\$10.27	C73-151-20	\$60.40	\$54.36	\$51.34

MILD STEEL BENT TABS



PACK OF (10)	HOLE DIA.	THICKNESS	HEIGHT	DISCOUNT PRICE PER PACK			BAG OF (20)	1 BAG	2 BAGS	3 BAGS
				1-3	4-5	6+				
C73-118-10	1/4"	3/32"	15/16"	\$9.40	\$8.46	\$7.99	C73-118-20	\$18.80	\$16.92	\$15.98
C73-119-10	3/8"	3/32"	15/16"	\$12.00	\$10.80	\$10.20	C73-119-20	\$24.00	\$21.60	\$20.40
C73-120-10	3/8"	1/8"	1"	\$11.20	\$10.08	\$9.52	C73-120-20	\$22.40	\$20.16	\$19.04
C73-121-10	7/16"	1/8"	1"	\$9.40	\$8.46	\$7.99	C73-121-20	\$18.80	\$16.92	\$15.98
C73-122-10	1/4"	3/32"	7/8"	\$12.00	\$10.80	\$10.20	C73-122-20	\$24.00	\$21.60	\$20.40
C73-123-10	3/8"	3/32"	7/8"	\$12.00	\$10.80	\$10.20	C73-123-20	\$24.00	\$21.60	\$20.40



PACK OF (4)	HOLE DIA.	THICKNESS	HEIGHT	DISCOUNT PRICE PER PACK			BAG OF (20)	1 BAG	2 BAGS	3 BAGS
				1-3	4-5	6+				
C73-124-4*	3/8"	1/8"	1-1/4"	\$14.24	\$12.82	\$12.10	C73-124-20	\$71.20	\$64.08	\$60.52
C73-125-4	1/4"	3/32"	1"	\$11.20	\$10.08	\$9.52	C73-125-20	\$56.00	\$50.40	\$47.60
C73-126-4	1/4"	3/32"	1-1/4"	\$12.20	\$10.98	\$10.37	C73-126-20	\$61.00	\$54.90	\$51.85
C73-127-4	1/4"	3/32"	1-3/4" C-C	\$13.32	\$11.99	\$11.32	C73-127-20	\$66.60	\$59.94	\$56.61

* Fits 1-1/2" diameter tube.

MILD STEEL / BRACKETS

TECH TIP

Mild Steel can be successfully welded to chromoly using the proper filling rod (see pg. 1). Always select chromoly tabs for applications requiring ultimate strength.

MILD STEEL CLEVIS LINK BRACKET



PART #	SIDE HOLES	MOUNT HOLE	QUANTITY DISCOUNT			BAG OF (20)	1 BAG	2 BAGS	3 BAGS
			1-39	40-59	60+				
C73-175*	1/2" DIA.	1/2" DIA.	\$9.59	\$8.63	\$8.15	C73-175-20	\$191.82	\$172.64	\$163.05
C73-176*	1/2" DIA.	5/8" DIA.	\$9.59	\$8.63	\$8.15	C73-176-20	\$191.82	\$172.64	\$163.05

* Both brackets are 3/16" thick and 1" wide inside.

MILD STEEL HINGE BRACKETS



PACK OF (4)	HOLE DIA.	THICKNESS	HEIGHT	DISCOUNT PRICE PER PACK			BAG OF (20)	1 BAG	2 BAGS
				1-9	10-14	15+			
C73-133-4	1/4"	3/32"	1-7/8"	\$6.58	\$5.92	\$5.59	C73-133-20	\$118.44	\$111.86

MILD STEEL FLANGES



C73-161-2



C73-164-2



C73-160-2



C73-163

PACK OF (2)	HOLE DIA.	THICKNESS	DIA.	TUBE APPLICATION	DISCOUNT PRICE PER PACK			BAG OF (20)	1 BAG	2 BAGS	3 BAGS
					1-19	20-29	30+				
C73-161-2	3/8"	1/4"	1-3/8"	FRAME	\$8.98	\$8.08	\$7.63	C73-161-20	\$89.80	\$80.82	\$76.33
C73-164-2	1/4"	3/16"	1"	FRAME	\$4.52	\$4.07	\$3.84				
C73-160-2	5/16"	1/4"	1-1/2"	FRAME	\$6.40	\$5.76	\$5.44	C73-160-20	\$64.00	\$57.60	\$54.40
*C73-163	1/4"	1/8"	7/8"	STEERING	\$2.26	\$2.03	\$1.92	C73-163-20	\$45.20	\$40.68	\$38.42

*1 per pack

MILD STEEL GUSSETS

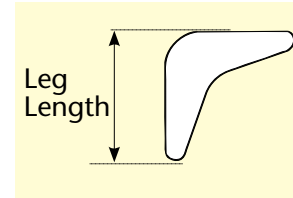
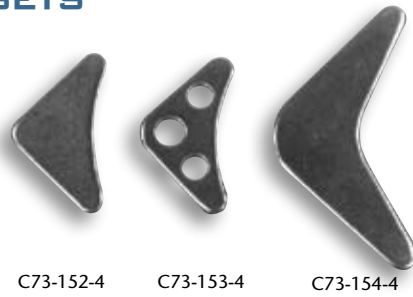

PACK OF (4)	THICKNESS	LEG LENGTH	DISCOUNT PRICE PER PACK			BAG OF (20)	1 BAG	2 BAGS	3 BAGS
			1-5	6-11	12+				
C73-152-4	1/8"	1-7/8"	\$2.60	\$2.34	\$2.21	C73-152-20	\$13.00	\$11.70	\$11.05
C73-153-4	1/8"	1-7/8"	\$2.20	\$1.98	\$1.87	C73-153-20	\$11.00	\$9.90	\$9.35
C73-154-4	1/8"	3"	\$5.52	\$4.97	\$4.69	C73-154-20	\$27.60	\$24.84	\$23.46

MILD STEEL PINTO RACK-N-PINION BRACKETS



PACK OF (1) PAIR	HOLE DIA.	THICKNESS	HOLE C-C SPACING	DISCOUNT PRICE PER PACK			BAG OF (20) PAIRS	1 BAG	2 BAGS	3 BAGS
				1-39	40-59	60+				
C73-172*	3/8"	3/16"	2-7/8"	\$12.79	\$11.51	\$10.87	C73-172-20	\$255.80	\$230.22	\$217.43

*Fits 1-1/2" diameter tube.

MILD STEEL SHOCK BRACKET



PACK OF (4)	DIMENSIONS	SIZE	QUANTITY DISCOUNT		
			1-39	40-59	60+
C73-155*	1/2" BOLT RADIUS MT (RIGHT) (TUBE DIA)	1-1/2"	\$8.50	\$7.65	\$7.23
C73-156*	1/2" BOLT RADIUS MT (LEFT) (TUBE DIA)	1-1/2"	\$8.50	\$7.65	\$7.23
C73-157*	1/2" BOLT FLAT MT (FLAT)	1-1/4"	\$8.50	\$7.65	\$7.23
C73-158*	1/2" BOLT FLAT MT (FLAT)	1-7/8"	\$8.50	\$7.65	\$7.23
C73-159*	1/2" BOLT 2 PC RADIUS TAB (TUBE DIA)	1-1/2"	\$8.50	\$7.65	\$7.23"

* Includes bushings.



C73-159

Bolt Not Included.

PACK OF (4)	DIMENSIONS	SIZE	DISCOUNT PRICE PER PACK		
			1-9	10-14	15+
C73-165-4	BUSHING ONLY	1/2" x 1/2"	\$4.00	\$3.60	\$3.40
C73-169-4	BUSHING ONLY	1/2" x 7/8"	\$5.12	\$4.61	\$4.35



CHROMOLY / BRACKETS

CHROMOLY BRACKETS

These high-strength chromoly chassis brackets take the hassle out of trying to cut & drill 4130 bracketry. Many popular styles to choose from.



CHROMOLY BENT TABS



C73-201-4



C73-202-4



C73-203-4



C73-207-4



C73-211-4

PACK OF (4)	HOLE DIA.	THICKNESS	HEIGHT	TUBE DIA.	DISCOUNT PRICE			BAG OF (20)	1 BAG	2 BAGS	3 BAGS
					1-9	10-14	15+				
C73-201-4	3/8"	1/8"	1-3/16"	1-1/4"	\$26.44	\$23.80	\$22.47	C73-201-20	\$132.20	\$118.98	\$112.37
C73-202-4	3/8"	1/8"	1-3/16"	1-1/4"	\$15.40	\$13.86	\$13.09	C73-202-20	\$77.00	\$69.30	\$65.45
C73-203-4	3/8"	1/8"	1-3/16"	1-1/4"	\$15.40	\$13.86	\$13.09	C73-203-20	\$77.00	\$69.30	\$65.45
C73-207-4	3/8"	1/8"	15/16"	-	\$13.37	\$12.03	\$11.36	C73-204-20	\$165.60	\$149.04	\$140.76
C73-211-4	3/16"	1/16"	7/8"	-	\$9.52	\$8.57	\$8.09	C73-211-20	\$47.60	\$42.84	\$40.46

CHROMOLY ROD END CLEVIS



C73-204-2



C73-205-2



C73-206-2

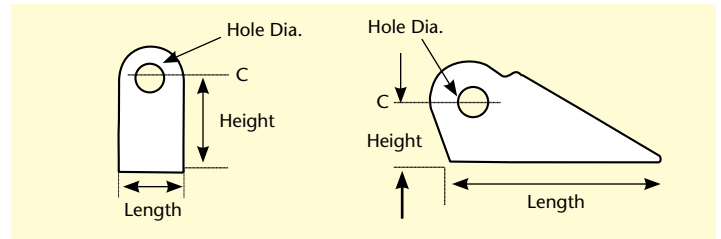

PACK OF (2)	HOLE DIA.	HEIGHT	LENGTH	INSIDE WIDTH	DISCOUNT PRICE			BAG OF (20)	1 BAG	2 BAGS	3 BAGS
					1-19	20-29	30+				
C73-204-2	3/8"	3/4"	2-3/4"	.500"	\$16.56	\$14.90	\$14.08	C73-204-20	\$165.60	\$149.04	\$140.76
C73-205-2	3/8"	1-1/8"	3/4"	.500"	\$10.52	\$9.47	\$8.94	C73-205-20	\$105.20	\$94.68	\$89.42
C73-206-2	3/8"	1-1/8"	1"	.500"	\$10.52	\$9.47	\$8.94	C73-206-20	\$105.20	\$94.68	\$89.42

CHROMOLY RADIUS TABS

If necessary, you can modify (grind) the radius of these tabs to fit larger diameter tubing.

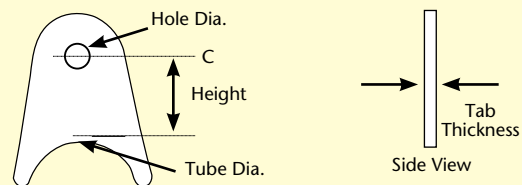

C73-229-4



C73-219-4



C73-208-4



C73-209-4



C73-210-4



C73-226-4
C73-227-4



C73-224-4

PACK OF (4)	HOLE DIA.	THICKNESS	HEIGHT	TUBE DIA.	DISCOUNT PRICE			BAG OF (20)	1 BAG	2 BAGS	3 BAGS
					1-9	10-14	15+				
C73-208-4	1/4"	1/8"	1/2"	1-1/4"	\$15.40	\$13.86	\$13.09	C73-208-20	\$77.00	\$69.30	\$65.45
C73-209-4	3/8"	1/8"	9/16"	1-1/4"	\$15.40	\$13.86	\$13.09	C73-209-20	\$77.00	\$69.30	\$65.45
C73-210-4	3/8"	1/8"	7/8"	1-1/4"	\$15.40	\$13.86	\$13.09	C73-210-20	\$77.00	\$69.30	\$65.45
C73-219-4	5/16"	1/8"	7/16"	1"	\$15.40	\$13.86	\$13.09	C73-219-20	\$77.00	\$69.30	\$65.45
C73-224-4	3/8"	1/8"	3/4"	1-3/8"	\$15.40	\$13.86	\$13.09	C73-224-20	\$77.00	\$69.30	\$65.45
C73-226-4	7/16"	1/8"	7/8"	1-3/8"	\$15.40	\$13.86	\$13.09	C73-226-20	\$77.00	\$69.30	\$65.45
C73-227-4	7/16"	3/16"	7/8"	1-3/8"	\$15.40	\$13.86	\$13.09	C73-227-20	\$77.00	\$69.30	\$65.45
C73-229-4	1/4"	1/8"	9/16"	1-1/8"	\$15.40	\$13.86	\$13.09	C73-229-20	\$77.00	\$69.30	\$65.45

CHROMOLY FLAT TABS

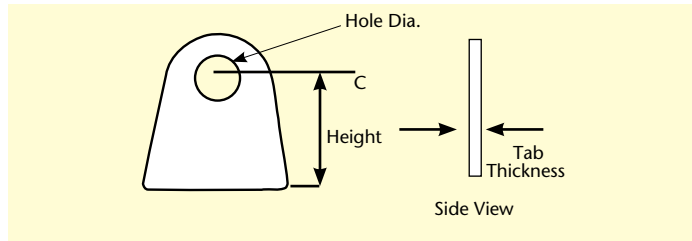

C73-217-4



C73-213-4
C73-218-4



C73-221-4



C73-231-4



C73-233-4
C73-234-4

PACK OF (4)	HOLE DIA.	THICKNESS	HEIGHT	DISCOUNT PRICE PER PACK			BAG OF (20)	1 BAG	2 BAGS	3 BAGS
				1-9	10-14	15+				
C73-213-4	5/16"	3/16"	11/16"	\$15.40	\$13.86	\$13.09	C73-213-20	\$77.00	\$69.30	\$65.45
C73-217-4	1/4"	1/8"	11/16"	\$15.40	\$13.86	\$13.09	C73-217-20	\$77.00	\$69.30	\$65.45
C73-218-4	5/16"	1/8"	11/16"	\$15.40	\$13.86	\$13.09	C73-218-20	\$77.00	\$69.30	\$65.45
C73-221-4	3/8"	3/16"	3/4"	\$15.40	\$13.86	\$13.09	C73-221-20	\$77.00	\$69.30	\$65.45
C73-231-4	7/16"	1/8"	1-1/8"	\$15.40	\$13.86	\$13.09	C73-231-20	\$77.00	\$69.30	\$65.45
C73-233-4	7/16"	1/8"	1-3/8"	\$15.40	\$13.86	\$13.09	C73-233-20	\$77.00	\$69.30	\$65.45
C73-234-4	7/16"	3/16"	1-3/8"	\$15.40	\$13.86	\$13.09	C73-234-20	\$77.00	\$69.30	\$65.45



C73-237-4



C73-236-4



C73-220-4



C73-239-4



C73-241-4



C73-242-4

PACK OF (4)	HOLE DIA.	THICKNESS	HEIGHT	DISCOUNT PRICE PER PACK			BAG OF (20)	1 BAG	2 BAGS	3 BAGS
				1-9	10-14	15+				
C73-220-4	5/16"	.095"	7/8"	\$15.40	\$13.86	\$13.09	C73-220-20	\$77.00	\$69.30	\$65.45
C73-236-4	5/16"	3/16"	9/16"	\$15.40	\$13.86	\$13.09	C73-236-20	\$77.00	\$69.30	\$65.45
C73-237-4	1/4"	1/8"	5/8"	\$15.40	\$13.86	\$13.09	C73-237-20	\$77.00	\$69.30	\$65.45
C73-239-4	5/16"	1/8"	5/8"	\$15.40	\$13.86	\$13.09	C73-239-20	\$77.00	\$69.30	\$65.45
C73-241-4	3/8"	1/8"	7/8"	\$15.40	\$13.86	\$13.09	C73-241-20	\$77.00	\$69.30	\$65.45
C73-242-4	5/16"	1/8"	1"	\$15.40	\$13.86	\$13.09	C73-242-20	\$77.00	\$69.30	\$65.45

CHROMOLY MOUNT BRACKETS

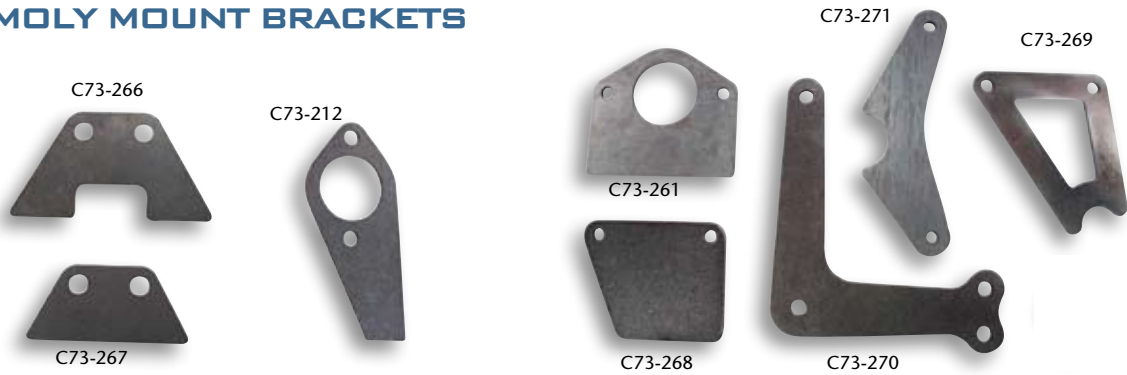

PART #	APPLICATION	DETAIL	QUANTITY DISCOUNT		
			1-39	40-59	60+
C73-212	MASTER CYLINDER	1/8" THICK	\$9.95	\$8.96	\$8.46
C73-261	WILWOOD TANDEM MASTER CYL	3/16" THICK	\$13.15	\$11.84	\$11.18
C73-266	STILLETTO RACK	1/8" THICK	\$9.85	\$8.87	\$8.37
C73-267	STILLETTO RACK (SHORT)	1/8" THICK	\$9.85	\$8.87	\$8.37
C73-268	MASTER CYL SIDE MT	3/16" THICK	\$11.50	\$10.35	\$9.78
C73-270	BELL CRANK STEERING ARM	1/4" THICK	\$32.95	\$29.66	\$28.01
C73-271	FRONT AXLE BRACKET FITS 1-1/2" DIA. TUBE	3/16" THICK	\$15.35	\$13.82	\$13.05
C73-269	MASTER CYL SIDE MT FITS 1" DIA. TUBE	1/8" THICK	\$18.65	\$16.79	\$15.85



CHROMOLY FUNNY CAR BOX MOUNTS

Available in two versions, this weld on chromoly bracket is 1/8" thick and is notched to accept a 1-1/8" dia. tube.

PART #	FITS	WELD AT	QUANTITY DISCOUNT		
			1-39	40-59	60+
C73-262	SPE	TOP	\$18.65	\$16.79	\$15.85
C73-263	SPE	BOTTOM	\$18.65	\$16.79	\$15.85



FRONT AND MID MOTOR PLATES

All of our Motor Plates are 6061-T6 aluminum, CNC precision machined "In House" to exact tolerances for optimum fit and finish.

PROFILED MID MOTOR PLATE

Designed to work with Pro-werks Profiled Front Motor Plates, this mid plate is ready to install. Available for either 1-1/4" or 1-1/2" diameter frame rails, plate has 19-1/2" centers on frame rail notches. Includes Chevy dowel pin locations, 6" diameter center hole, and two 2" diameter vent holes.

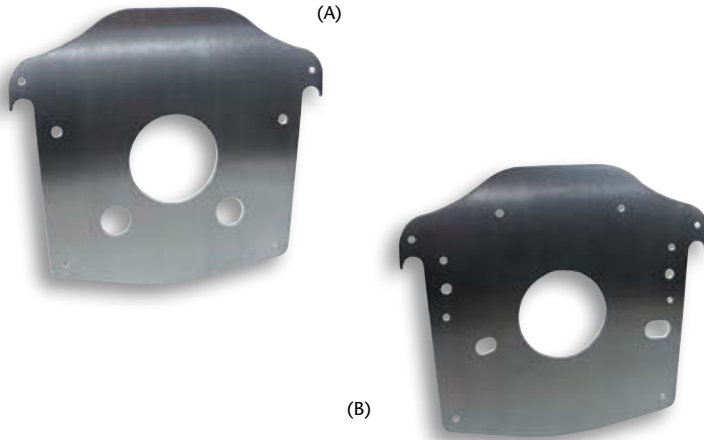

REF	PART #	DESCRIPTION	THICKNESS	NOTCH	PRICE
(A)	C52-400	UNIVERSAL	1/4"	1-1/4"	\$172.95
(A)	C52-405	UNIVERSAL	1/4"	1-1/2"	\$172.95
(A)	C52-401	UNIVERSAL	3/8"	1-1/4"	\$198.95
(A)	C52-406	UNIVERSAL	3/8"	1-1/2"	\$198.95
(B)	C52-410	SB & BB CHEVY	1/4"	1-1/4"	\$176.95
(B)	C52-415	SB & BB CHEVY	1/4"	1-1/2"	\$176.95
(B)	C52-411	SB & BB CHEVY	3/8"	1-1/4"	\$207.95
(B)	C52-416	SB & BB CHEVY	3/8"	1-1/2"	\$207.95

PROFILED FRONT MOTOR PLATE

Plate is ready to install and is complete with holes for chassis tabs. Notched at 1-3/8" diameter to accept floating saddle mounts or direct mounts, plate has 19-1/2" centers on frame rail notches.



PART #	DESCRIPTION	THICKNESS	PRICE
C52-550	SB CHEVY	1/4"	\$99.95
C52-551	SB CHEVY	3/8"	\$132.95
C52-555	BB CHEVY	1/4"	\$99.95
C52-556	BB CHEVY	3/8"	\$132.95

FLOATING SADDLE MOUNT

This all chromoly constructed mount is tig welded. Clamps are sold separately; see Pro-werks Stainless Steel Clamp at right.



PART #	FITS DIA.	USES CLAMP	PRICE
C73-321	1"	C73-303	\$28.95
C73-322	1-1/8"	C73-304	\$28.95
C73-323	1-1/4"	C73-304	\$28.95
C73-324	1-3/8"	C73-306	\$28.95
C73-325	1-1/2"	C73-307	\$28.95
C73-326	1-5/8"	C73-307	\$28.95

STAINLESS CLAMP

Positive grip band clamps are ideal for floating saddle mounts, add-on brackets, or hose sealing. Fine thread t-bolt includes self-locking nut. Two clamps recommended for most applications.



Shown installed with clamps

PART #	DIA.	CLAMP RANGE	PRICE
C73-303	1.125"	1" TO 1-3/16"	\$7.95
C73-304	1.312"	1-1/4" TO 1-7/16"	\$7.95
C73-306	1.5"	1-7/16" TO 1-5/8"	\$7.95
C73-307	1.625"	1-1/2" TO 1-7/8"	\$7.95



FRONT MOTOR PLATE

Provides increased chassis strength. Allows easy engine installation and removal. Plate is precision CNC machined from 6061-T6 aluminum, and includes water passages. May be trimmed to fit your application.

PART #	DESCRIPTION	MOUNTING LOCATION	H x W x THK	PRICE
C52-500	SB CHEVY	BLOCK TO PUMP	11" x 36" x 1/4"	\$110.95
C52-501	BB CHEVY	BLOCK TO PUMP	11" x 36" x 1/4"	\$110.95
C52-505	SB MOPAR	PUMP TO COVER	11" x 36" x 1/4"	\$117.95
C52-506	BB MOPAR	BLOCK TO PUMP	11" x 36" x 1/4"	\$117.95
C52-510	SB FORD	PUMP TO COVER	11" x 36" x 1/4"	\$116.95
C52-515	BB FORD	PUMP TO COVER	11" x 36" x 1/4"	\$116.95
C52-520	CLEVELAND FORD	PUMP TO COVER	11" x 36" x 1/4"	\$116.95



C52-500



C52-501

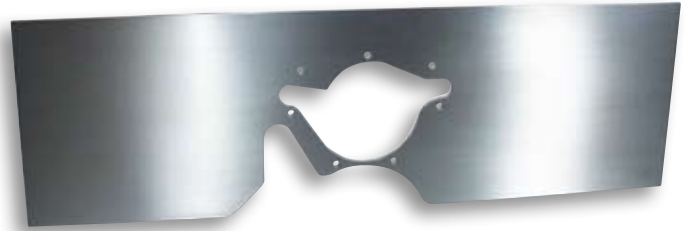

C52-505



C52-506



C52-510



C52-515



C52-520



MID MOTOR PLATE

Precision CNC machined from 6061-T6 aluminum, these plates may be trimmed to fit your particular application.



C52-302/C52-303



C52-311/C52-312



C52-321/C52-322



C52-324/C52-326



C52-336/C52-337



C52-346/C52-347



C52-356/C52-357



C52-366/C52-367



C52-421



C52-424



C52-436



C52-446



C52-456



C52-466

PART #	BOLT PATTERN	H x W x THK	PRICE
C52-302	BLANK	24" x 24" x 1/4"	\$93.95
C52-311	CENTER HOLE ONLY	24" x 24" x 1/4"	\$110.95
C52-321	*SB & BB CHEVY	24" x 24" x 1/4"	\$132.95
C52-324	UNIVERSAL	24" x 24" x 1/4"	\$128.95
C52-336	*SB MOPAR	24" x 24" x 1/4"	\$143.95
C52-346	*BB MOPAR	24" x 24" x 1/4"	\$143.95
C52-356	*SB FORD	24" x 24" x 1/4"	\$143.95
C52-366	*BB FORD	24" x 24" x 1/4"	\$143.95
C52-303	BLANK	24" x 24" x 3/8"	\$139.45
C52-312	CENTER HOLE ONLY	24" x 24" x 3/8"	\$154.95
C52-322	*SB & BB CHEVY	24" x 24" x 3/8"	\$176.95
C52-326	UNIVERSAL	24" x 24" x 3/8"	\$172.95
C52-337	*SB MOPAR	24" x 24" x 3/8"	\$187.95
C52-347	*BB MOPAR	24" x 24" x 3/8"	\$187.95
C52-357	*SB FORD	24" x 24" x 3/8"	\$187.95
C52-367	*BB FORD	24" x 24" x 3/8"	\$187.95
C52-421	*SB & BB CHEVY	24" x 36" x 1/4"	\$187.95
C52-424	UNIVERSAL	24" x 36" x 1/4"	\$183.95
C52-436	*SB MOPAR	24" x 36" x 1/4"	\$198.95
C52-446	*BB MOPAR	24" x 36" x 1/4"	\$198.95
C52-456	*SB FORD	24" x 36" x 1/4"	\$198.95
C52-466	*BB FORD	24" x 36" x 1/4"	\$198.95

*Includes dowel pin locations and starter hole.

AUTO ADAPTER PLATE

This aluminum plate adapts Chevy Powerglide Turbo 350 or 400 transmissions to a VW air-cooled engine. Includes transmission dowel pins to ensure accurate alignment. Measures 1/4" thick, 18-1/2" tall, and 20" wide.



PART #	DESCRIPTION	PRICE
C12-300	AUTO ADPT PLATE	\$195.95